

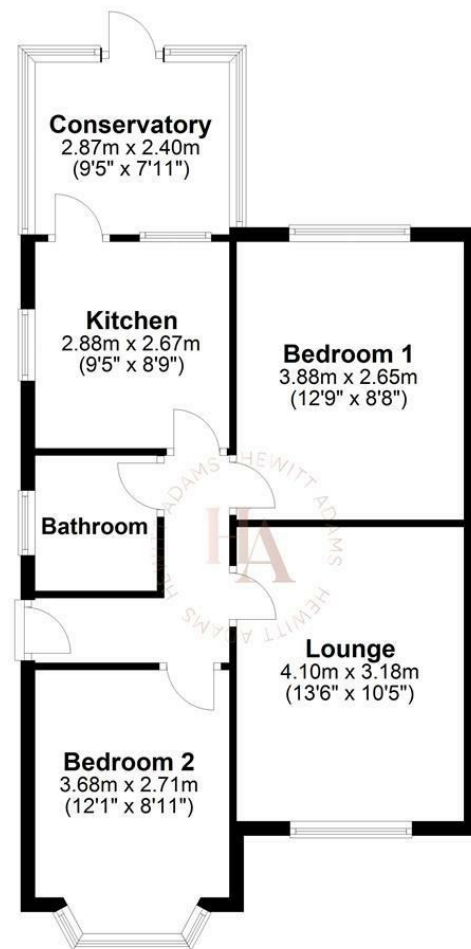

**Ground Floor**

Approx. 59.1 sq. metres (636.5 sq. feet)



Total area: approx. 59.1 sq. metres (636.5 sq. feet)  
For illustration purposes only - not to scale

**Shearman Close, Pensby, Wirral CH61 9PA**

**£230,000**

2 Bedroom 1 Reception 1 Bathroom

**Front Entrance**

Into;

**Hall**

Radiator, power points

**Lounge**

10'5" x 13'5" (3.18 x 4.1)

Double glazed window, radiator, power points, fireplace

**Kitchen**

8'9" x 9'5" (2.67 x 2.88)

Wall and base units, spaces for white goods, inset sink, double glazed window, door into conservatory

**Bathroom**

Comprising bath, low level W.C, wash hand basin, double glazed window

**Bedroom One**

8'4" x 12'8" (2.55 x 3.88)

Double glazed window, radiator, power points, wardrobes

**Bedroom Two**

12'0" x 9'1" (3.68 x 2.77)

**Conservatory**

Overlooking the rear garden

**EXTERNALLY**

Front Aspect - Driveway with Garage

Rear Aspect - Large Corner Plot with a HUGE REAR garden comprising lawn, patio areas and flowerbeds

